

Dimensions in “mm”

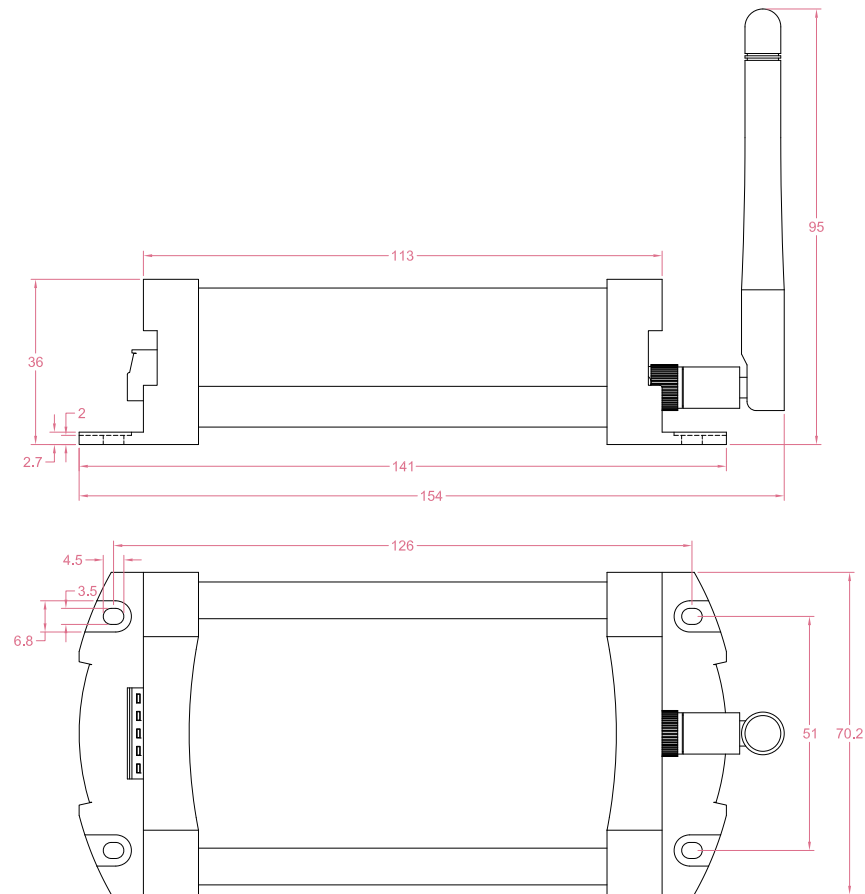

Model WTA includes a transmitter and a receiver with the same size.

Specifications		
Radio Frequency		433MHz
Wireless Transmission Distance		Up to 500m in open space
Stabilization Time		≈2.5s
Transmitter	Power Supply	Built-in rechargeable battery or Powered via Type-C interface
	Battery Capacity	4000mAh
	Battery Charging Time	6~8h
	Full-charge Operating Time	>48h
Receiver	Power Supply	5V DC (Normally powered by the indicator)
Working Temperature		-10...+50°C
Material of Housing		Aluminum
IP Rating		IP50

• LCS reserves the right to modify its design and specifications without notice

P:1/2

## Interface Overview

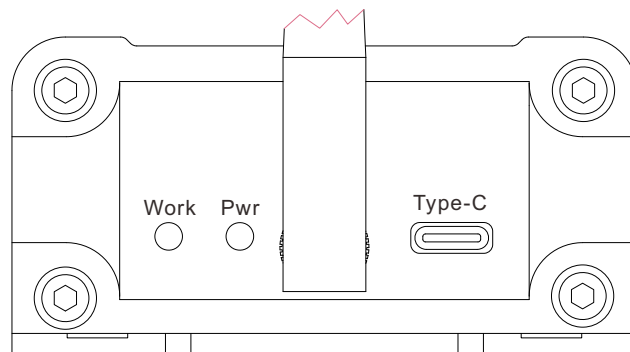
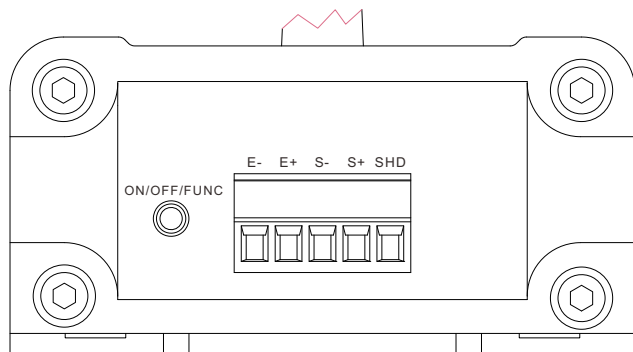

### ON/OFF/FUNC: Power switch

Short press to power on when it is off; press and hold for 3s to power off when it is on.

### E-/E+/S-/S+/SHD: Wiring terminal

Transmitter: Connected to the sensor.

Receiver: Connected to the indicator.

### Work: Work indicator

Transmitter: When the module is operating normally, the green indicator flashes.

Receiver: When the module is operating normally, the red indicator flashes rapidly.

### Pwr: Power indicator

Transmitter: A solid green light indicates the battery is fully charged;  
a solid red light indicates low battery voltage.

Receiver: When the indicator is powered on, the receiver's red LED remains on,  
indicating it is in standby mode.

### Type-C: Interface

Transmitter: Charging or power supply port.

Receiver: No function.

## Wiring Example

